

NOTE: BREAK ALL CORNERS WITH 0.015" (.38 MM) RADIUS UNLESS OTHERWISE NOTED. STANDARD TOLERANCES TO APPLY UNLESS OTHERWISE SPECIFIED.

CUSTOMER PART No.	<b>CAN ART STD.</b>	DIE No. <b>ES05508</b>
DESCRIPTION	2 1/2" x 3/16" THK. FLAT BAR	PROPOSAL No. <b>S-5164</b>

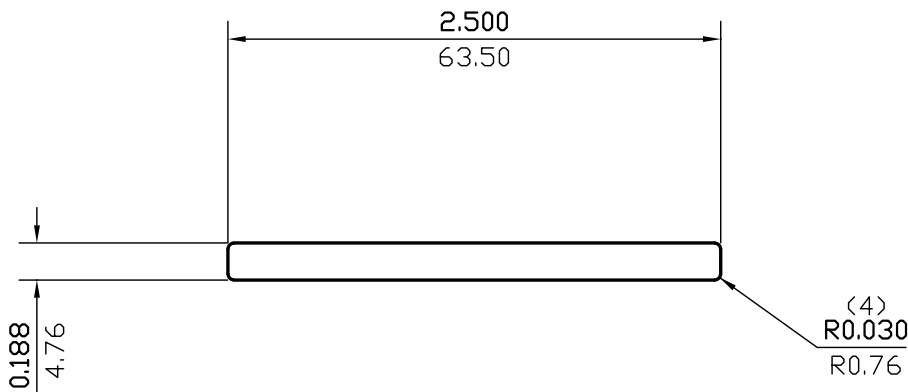

WALL THICKNESS (AS SHOWN) EXCEPT AS SHOWN

DATE	REV	DESCRIPTION	BY
03/17/23	2	REMOVED ALLOY	JASON
08/13/99	1	REDRAWN	P.M.
EST.AREA	0.468	IN. <sup>2</sup>	EST.AREA 302
			MM. <sup>2</sup>
EST.WT.	0.552	LBS/FT.	EST.WT. 0.822
			KG/M.
EST.PER.	5.323	IN.	EST.PER. 135.2
			MM.
OUT PER.		IN.	OUT PER.
			MM.
C.C.D.	2.503	IN.	C.C.D. 64
			MM.
FACTOR	10	FINISH	M/F
		ALLOY & TEMP.	
CKD BY	SCALE	1:1	DWN BY C.P. DATE 02/21/96

# CAN ART

ALUMINUM EXTRUSION INC.

85 PARKSHORE DRIVE  
 BRAMPTON, ONT L6T 5M1  
 TEL. NO. (905) 791-1464  
 FAX NO. (905) 791-9151  
 E-MAIL: canart@canart.com

THIS DRAWING IS NOT NECESSARILY A COPY OF YOUR ORIGINAL. PLEASE APPROVE DIMENSIONS AND TOLERANCES INDICATED. CAN ART ASSUMES NO RESPONSIBILITY EITHER TECHNICAL OR LEGAL FOR HAVING THIS SHAPE MADE. THE CUSTOMER AGREES TO FULLY PROTECT CAN ART ALUMINUM FROM CLAIMS OF OTHERS RESULTING FROM THIS SHAPE.

SIGNED: \_\_\_\_\_ DATE: \_\_\_\_\_